





Standard



Outlook door
option



 De Maple is een stijlvol vakantiehuis dat een ruime woonkamer combineert met een scala aan functies van de hoogste kwaliteit, dit is ook terug te zien in de twee en drie slaapkamers. Hier vindt u een luxe stoffering in een tijdloze kleurstelling, goed geplande kamers en een stijlvolle buitenkant.

 Das Modell Maple ist ein stilvolles Mobilheim, welches einen großzügigen Wohnbereich mit einer Sammlung von exklusiven Extras kombiniert. Die hochwertige Verarbeitung setzt sich bis in die Schlafzimmer durch. Hier finden Sie z.B. eine Komfortpolsterung, gut geplante Räume und ein stilvolles Äußeres.

 Le Maple est un mobil-home d'un grand style combiné avec de grands espaces et toutes les options. Une finition parfaite pour ce mobil-home en 2 ou 3 chambres. Vous y trouverez des meubles de luxe, des chambres bien planifiées et un extérieur très prometteur.

All Maple photography is of the 1100/2 Super unless otherwise stated, other models may vary in layout and features. The model shown has the following options and extras: 1 door 1225 fridge freezer and single socket in shower vanity top unit.







Standaardfuncties

- Standaard chassis
- Kunststof buitenbekleding
- Pannendak
- Kunststof goten met regenpijpen
- Buitenlamp
- Dissel aan beide kanten te plaatsen
- Dubbel glas
- Centrale verwarming
- Extra isolatie
- Spits plafond
- Vrijstaande eettafel & stoelen
- Slaapbank in woonkamer
- Afzuigkap
- Geïntegreerde koel-/vriescombinatie (1225mm)
- Luxe kooktoestel
- Ruimte voor magnetron
- Complete vinyl vloer
- Grote douchecabine

Beschikbare Opties

- Pre gegalvaniseerd chassis
- Openslaande tuindeuren
- Vakverdeling in ramen en deuren



Standard-Funktionen

- Lackiertes Fahrgestell
- Außenverkleidung Kunststoff
- Stahlziegeldach
- Kunststoff Dachrinnen mit Fallrohren
- Außenlampe
- Abnehmbare Zugdeichsel zusätzlich
- Doppelverglasung
- Gaszentralheizung
- Zusätzliche Isolierung
- Spitzdach-Decke
- Freistehender Esstisch & Stühle
- Schlafcouch im Wohnzimmer
- Dunstabzugshaube
- Integrierte Kühl-Gefrier-Kombination (1225mm)
- 4-Flamm-Gaskochfeld mit Gas-
- Backofen und Grillfunktion
- Aussparung für Mikrowelle
- Fußboden komplett PVC
- Große Duschkabine

Verfügbaren Optionen

- Verzinktes Fahrgestell
- Terrassentüren vorne
- Sprossenfenster und -türen möglich



Caractéristiques Standard

- Châssis peint
- Revêtement extérieur en PVC
- Toit en tuiles
- Gouttières et descentes en PVC
- Lumière extérieure
- Timon réversible
- Double vitrage
- Chauffage central
- Isolation renforcée
- Plafonds voûtés
- Table et chaises
- Canapé convertible au salon
- Hotte aspirante
- Frigo-congélateur intégré (1225mm)
- Cuisinière intégrée
- Emplacement micro-ondes
- Revêtement de sol en vinyl imitation parquet
- Grande cabine de douche

Options Disponibles

- Châssis pré-galvanisé
- Porte d'entrée vitrée
- Fenêtres avec des croisillons

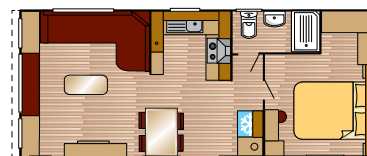

900/1 Super

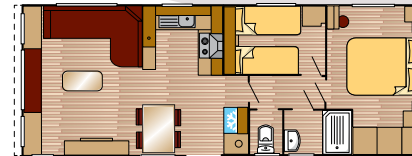

1000/2 Super

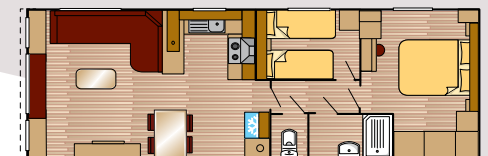

1100/2 Super

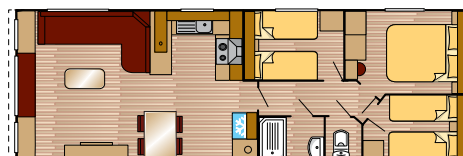

1100/3 Super

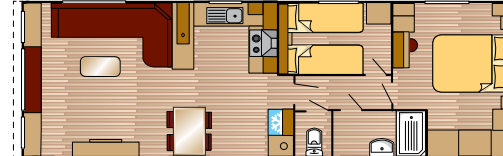

1150/2 Super

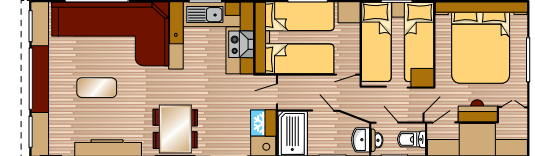

1150/3 Super

Features & Options

		Redwood	Bellevue	Mulberry Neb	Mulberry	Scala	Willow Classic	Willow	Juniper	Maple	Relax	Retreat	Andes	Azure Deluxe 370	Azure Deluxe 315	Europa Deluxe	
Exterior	Painted chassis	X	X	S	S	S	S	S	S	S	S	S	S	S	S	S	S Standard
	Pre galvanised chassis	X	X	O	O	O	O	O	O	O	O	O	O	O	O	O	O
	Chassis fully galvanised 10 year warranty	S	S	O	O	O	O	O	O	O	O	O	O	O	O	O	O Optional
	Plain aluminium exterior	X	X	X	X	X	X	X	X	X	X	X	X	X	O	O	O
	uPVC cladded exterior	O	S	S	S	S	S	S	S	S	S	S	S	S	S	S	X Not Available
	CanExel cladded exterior	S	X	X	X	X	X	X	X	X	X	X	X	X	X	X	X
	Exterior door canopy	X	O	X	X	X	X	X	X	X	X	X	X	X	X	X	X
	Environmental green exterior	O	O	O	O	O	O	O	O	O	O	O	O	O	O	O	O
	Pan tiled roof	S	S	S	S	S	S	S	S	S	S	S	S	S	S	S	S
	Domestic style gutters	S	S	S	S	S	S	S	S	S	S	S	S	S	S	S	S
	Outlook doors	S	O	O	O	O	O	O	S	O	X	S	X	X	X	X	X
	Exterior light	S	S	S	S	S	S	S	S	S	S	S	S	S	S	S	O
	Reversible tow-bar facility	S	S	S	S	S	S	S	S	S	S	S	S	S	S	S	S
Insulation/ Heating	uPVC Double glazed	S	S	S	S	S	S	S	S	S	S	S	S	S	S	S	
	Central heating	S	S	S	S	S	S	S	S	S	S	S	O	O	O	O	
	Electric plinth heaters	O	O	O	O	O	O	O	O	O	O	O	O	O	O	O	
	External pipe lagging	S	S	S	S	S	S	S	S	S	S	S	S	S	S	S	
	25mm fibreglass floor Insulation	S	S	S	S	S	S	S	S	S	S	S	S	S	S	S	
	25mm fibreglass wall insulation	X	X	X	X	X	X	X	X	X	X	X	X	X	O	O	O
	50mm fibreglass wall insulation	S	S	S	S	S	S	S	S	S	S	S	S	O	O	O	
	25mm fibreglass roof Insulation	X	X	X	X	X	X	X	X	X	X	X	X	X	S	S	S
	50mm fibreglass roof Insulation	S	S	S	S	S	S	S	S	S	S	S	S	O	O	O	
Roof insulation'Drantherm' bubble foil	S	S	S	S	S	S	S	S	S	S	S	S	S	S	S		
Lounge/ Dining	Electric fire	S	S	S	S	X	S	S	S	S	S	X	O	O	O	O	
	Truma fire	X	X	X	X	X	X	X	X	X	X	X	S	S	S	S	
	Vaulted ceilings throughout	S	S	S	S	S	S	S	S	S	S	S	S	S	S	S	
	Dividing door to hallway	S	S	S	S	S	S(1)	S(1)	X	S(2)	X	X(3)	X(4)	X	X	X	
	Net curtains throughout	O	X	O	O	X	S	S	S	S	O	O	S	S	S	S	
	Free standing dining table & chairs	S	S	S	S	S	S	S	S	S	S	X	S(5)	S	S	S	
	Metal action fold out bed to lounge seating	S	S	S	S	S	S	S	S	S	S	X	S	S	S	O	
Kitchen	Cooker hood vented to outside	S	S	S	S	S	S	S	S	S	S	S	S	S	S	S	
	Integrated microwave	S	S	S	S	S	S	S	O	O	O	O	O	O	O	O	
	Undercounter fridge with ice box	X	X	X	X	X	X	X	X	X	S	X	X	S	S	S	
	Integrated fridge freezer (1225mm)	X	X	X	X	X	X	X	S	S	O	X	S	O	O	O	
	Integrated fridge freezer (full size)	S	S	S	S	S	S(6)	S(6)	O	O	O	S	O	O	O	O	
	Hob	X	X	O	O	S	O	O	O	O	S	S	S	S	S	S	
	Integrated cooker	X	X	X	X	O	X	X	S	S	O	O	O	O	O	O	
	Integrated cooker with LED clock/minute minder	X	X	S	S	O	S	S	O	O	O	O	O	O	O	O	
	Integrated oven & grill with separate hob	S	S	X	X	X	X	X	X	X	X	X	X	X	X	X	X
	Integrated 450mm wide dishwasher	S	S	O	O	O	O	O	O	O	O	O	O	O	O	O	O
Bathroom	Shower with thermostatic mixer	S	O	O	O	O	O	O	O	O	O	O	O	O	O	O	
	Dual flush WC	S	S	S	S	S	S	S	S	S	S	S	S	S	S	S	
	Bath with thermostatic mixer shower over	S(7)	X	X	X	X	X	X	X	X	X	X	X	X	X	X	
	Extractor fan	S	S	S	S	S	S	S	S	S	S	S	S	S	S	S	
Bedroom	Lift up storage bed to main bedroom	X	S	S	S	O	S	S	O	O	O	O	O	O	O	O	
	Divan bed with storage	S	X	X	X	X	X	X	X	X	X	X	X	X	X	X	
	Gazunder bunk beds	O	O	O	O	O	O	O	O	O	O	O	O	O	O	O	
	Deluxe mattress upgrade	S	S	O	O	O	O	O	O	O	O	O	O	O	O	O	
	Tuftained mattresses	O	O	O	O	O	O	O	O	O	O	O	O	O	O	O	
	Padded headboards	S	S	S	S	S	S	S	S	S	X	X	S	S	S	X	
Safety	Smoke alarm (10 year battery)	O	O	O	O	O	O	O	O	O	O	O	O	O	O	O	
	Carbon monoxide detectors (7 year battery)	O	O	O	O	O	O	O	O	O	O	O	O	O	O	O	
	Fire extinguisher	O	O	O	O	O	O	O	O	O	O	O	O	O	O	O	
	Fire blanket	O	O	O	O	O	O	O	O	O	O	O	O	O	O	O	